

# Quick Start Guide

## Get to know your frame

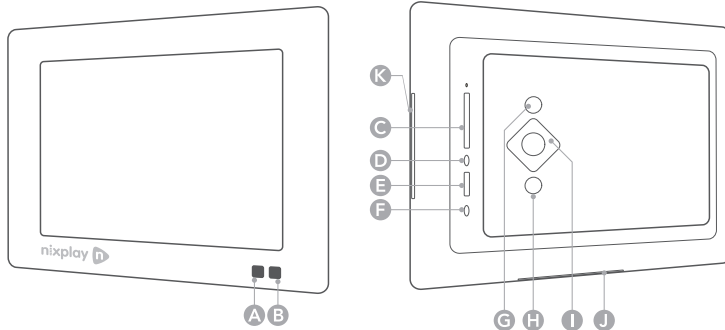

### Function

- A Motion Sensor**  
Senses movement and turns the Cloud Frame ON and OFF
- B IR Receiver for Remote**  
Receives signals from the remote
- C SD/SDHC Card Slot**  
Insert your memory card and view your photos and videos
- D Headphone/Speaker Port**  
Connect your headphones or speakers
- E USB Port**  
Connect your USB flash drive and view your photos and videos
- F Power Adapter DC-in (5V) -**  
Plug-in power cable for power
- G ON/OFF Button**  
Press and hold to power on the Cloud Frame
- H Menu Button**  
This will take you to the main menu
- I 4-way Menu Control & PLAY Button**  
Helps you navigate and select
- J Stand Slot (Horizontal) of W13A**  
For landscape display
- K Stand Slot (Vertical) of W13A**  
For portrait display

## Remote

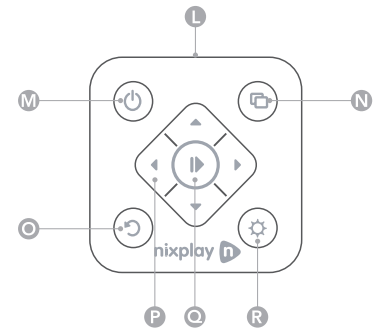

- L Infrared Transmitter**
- M On / Off**
- N Display Playlists**
- O Back**
- P Navigation Menu**
- Q Select / Play / Pause**
- R Settings**

For warranty information, please visit our website: [www.nixplay.com](http://www.nixplay.com)  
If you need help, please contact our support team at: <http://support.nixplay.com>



W08C model

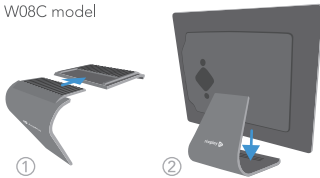

### 1. Assemble frame & stand

(W08C model)

- ▶ ① Slide the two pieces together to create Stand. ② Place frame on Stand.
- ▶ **IMPORTANT:** Place the frame next to a computer for the set up process.

W13A model

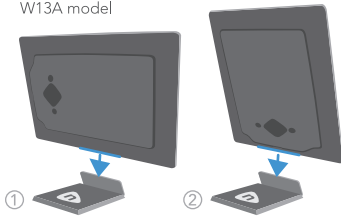

(W13A model)

- ▶ Slide stand into ① stand slot (Horizontal) OR ② stand slot (Vertical).
- ▶ **IMPORTANT:** Place the frame next to a computer for the set up process.

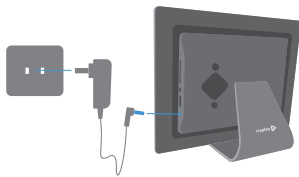

### 2. Plug in power adaptor to frame and power source

- ▶ Once plugged in, the frame will automatically start up.
- ▶ When you reach the 'Welcome Screen', please use the **remote** or **the controls** on the back of the frame to navigate your frame set up.



### 3. Connect to WiFi network

- ▶ Using the remote or the controls on the back of the frame, select the WiFi network you wish to connect to and press ▶. If required, please enter the WiFi password and select **CONNECT**.
- ▶ **Note:** An automatic software update may take place. Please wait a few minutes and do not switch off or unplug your frame during this process.



### 4. Add Frame to a Nixplay Cloud Account

- ▶ Once your frame is connected to your Wi-Fi network, please follow the instructions on your frame's display until your frame displays a 16-digit serial number.
- ▶ Please visit [www.nixplay.com/setup](http://www.nixplay.com/setup) to create an account and follow the instructions in your browser to complete the set-up process (if you are an existing Nixplay user, simply log in to pair your frame).  
**IMPORTANT:** Please ensure that your computer is using the latest browser version.
- ▶ Congratulations, you have now successfully setup your frame. Start your Nixplay experience!

On your browser you can click the Welcome tab and we have Video Tutorials here to guide you through an exciting visual tour.